

Quality products

ISOHEAT®

MiL fittings overview



Description:

Our heated hoses we deliver in standard with fitting in bichromated steel. As option all fittings available in stainless steel (1.4305 or 1.4571) or brass.

Dimension of fitting depending from inner diameter of core. Please note, that inner diameter of fitting is smaller than inner diameter of core.

diameter nominal DN	mm	4	6	8	10	12	16	20	25	32	40
inner diameter fitting	mm	3,0	4,5	6,0	7,5	10	12,5	16	20,1	27,5	31,5

DKR (DIN 3863)

universal conical nipple,
union nut inch (BSP)

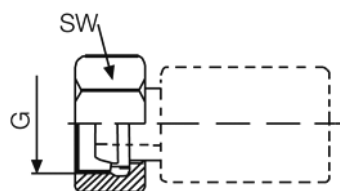

nominal width DN (NW)	thread Inches	SW
4	G 1/8"	15
4	G 1/4"	17
6	G 1/4"	17
6	G 3/8"	19
10	G 3/8"	19
10	G 1/2"	27
12	G 1/2"	27

nominal width DN (NW)	thread inches	SW
16	G 1/2"	32
20	G 3/4"	32
20	G 1"	41
25	G 1"	41
25	G 1 1/4"	50
32	G 1 1/4"	50
40	G 1 1/2"	56

DKJ (DIN 3863)

nipple with 74°-conus JIC,
union nut UNF-thread

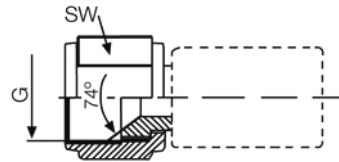

nominal width DN (NW)	thread UNF	SW
6	7/16-20	14
6	7/2-20	17
6	9/16-16	17
8	1/2-20	17
8	9/16-18	17
10	3/4-16	24
12	3/4-16	24

nominal width DN (NW)	thread UNF	SW
13	7/8-14	27
16	7/8-14	27
16	1 1/16-12	32
20	1 1/16-12	32
25	1 5/16-12	38
32	1 5/8-12	51
40	1 7/8-12	56

RSL

pipe connection light

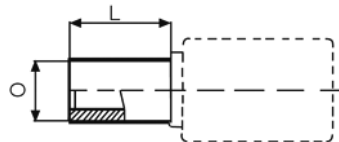

nominal width DN (NW)	pipe-Øa mm	length mm
4	6	25
6	8	25
8	10	26
10	12	26
12	15	28

nominal width DN (NW)	pipe-Øa mm	length mm
16	18	32
20	22	32
25	28	34
32	35	41
40	42	41

RSS

pipe connection heavy

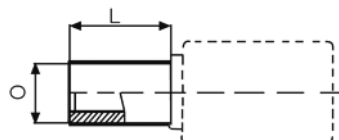

nominal width DN (NW)	pipe-Øa mm	length mm
4	8	27
6	10	29
8	12	29
10	14	33
12	16	33

nominal width DN (NW)	pipe-Øa mm	length mm
16	20	39
20	25	44
25	30	48
32	38	55

DKL (DIN 3863)

universal conical nipple,
union nut metric thread light

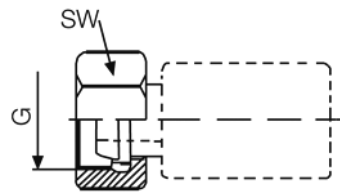

nominal width DN (NW)	thread Inches	SW
4	M 12 x 1,5	17
6	M 14 x 1,5	17
8	M 16 x 1,5	19
10	M 18 x 1,5	22
12	M 22 x 1,5	27

nominal width DN (NW)	thread inches	SW
16	M 26 x 1,5	32
20	M 30 x 2	36
25	M 36 x 2	41
32	M 45 x 2	50
40	M 52 x 2	60

DKM (DIN 3863)

universal conical nipple,
union nut metric thread

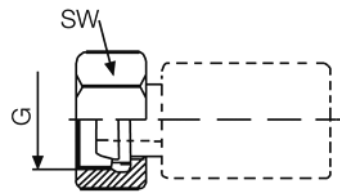

nominal width DN (NW)	thread Inches	SW
20	M 30 x 1,5	36
25	M 38 x 1,5	46

nominal width DN (NW)	thread Inches	SW
32	M 45 x 1,5	32
40	M 52 x 1,5	36

DKS (DIN 3863)

universal conical nipple,
union nut metric heavy

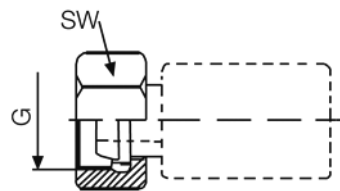

nominal width DN (NW)	thread Inches	SW
6	M 18 x 1,5	22
8	M 20 x 1,5	22
10	M 22 x 1,5	27
12	M 24 x 1,5	30

nominal width DN (NW)	thread Inches	SW
16	M 30 x 2	32
20	M 36 x 2	36
25	M 42 x 2	41
32	M 52 x 2	50

BDN

flanged nut flat packing,
union nut inch / BSP

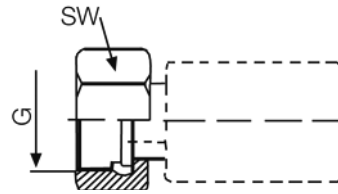

nominal width DN (NW)	thread Inches	SW
4	G 1/4"	17
6	G 1/4"	17
8	G 3/8"	19
10	G 3/8"	19
10	G 1/2"	27
12	G 1/2"	27
16	G 3/4"	32

nominal width DN (NW)	thread Inches	SW
20	G 3/4"	32
20	G 1"	41
25	G 1"	41
25	G 1 1/4"	50
32	G 1 1/4"	50
40	G 1 1/2"	56

BDN

flanged nut flat packing,
union nut metric

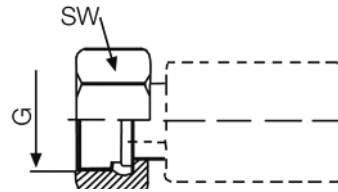

nominal width DN (NW)	thread Inches	SW
4	M 12 x 1,5	17
6	M 14 x 1,5	17
8	M 16 x 1,5	19
10	M 18 x 1,5	22
12	M 22 x 1,5	27

nominal width DN (NW)	thread Inches	SW
16	M 26 x 1,5	32
20	M 30 x 2	36
25	M 36 x 2	41
32	M 45 x 2	50
40	M 52 x 2	60

Heating hoses can be delivered also with loose or fix-flanges as DIN or ASA.
Special constructions available on request.

MiL Heating Systems
Großer Sand 4
D-76698 Umstadt-Weiher

Phone + 49 (0) 72 51 - 93247 - 0
Fax + 49 (0) 72 51 - 93247 - 29

E-Mail: info@isoheat.de
Internet: www.isoheat.de